

PROPERTY LAYOUT

THE SPA ON PORT ROYAL SOUND  
 239 BEACH CITY ROAD  
 HILTON HEAD ISLAND, SC 29926

(843) 689-7500 - OFFICE  
 (843) 620-1024 - FAX

FRONTDESK@THESPAONPORTROYALSOUND.COM

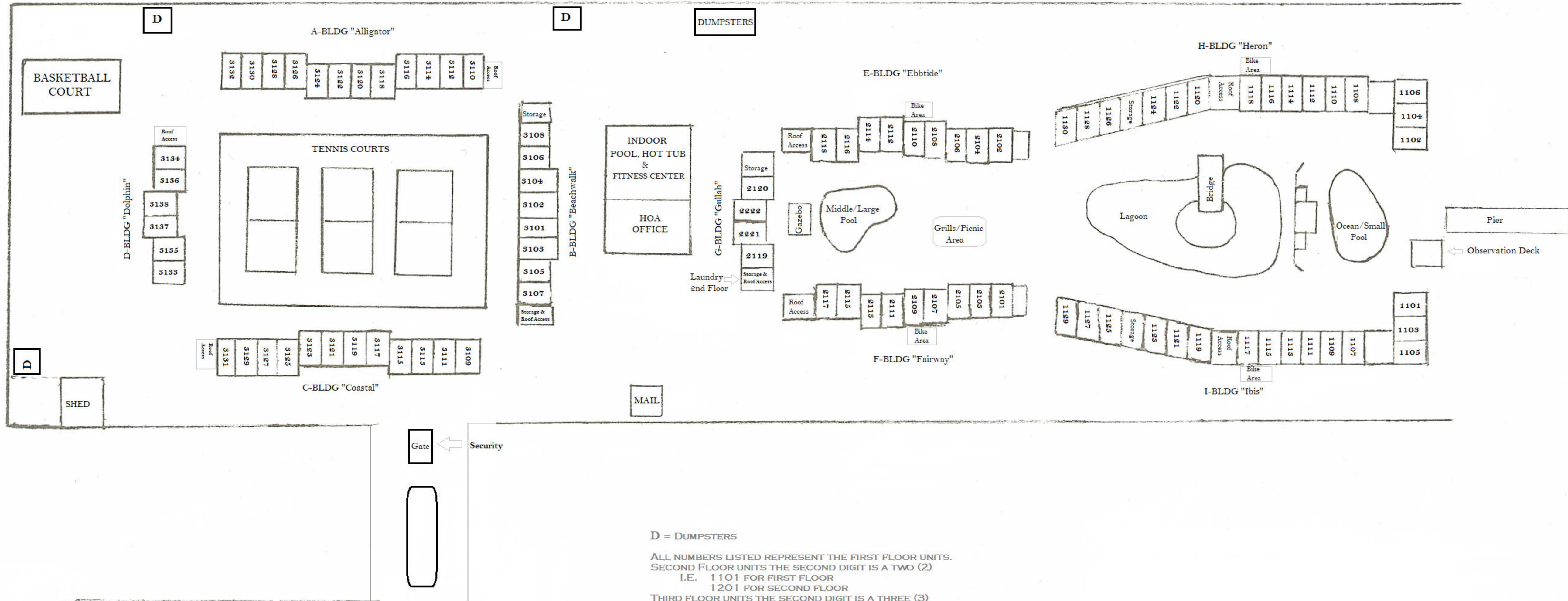

D = DUMPSTERS

ALL NUMBERS LISTED REPRESENT THE FIRST FLOOR UNITS.  
 SECOND FLOOR UNITS THE SECOND DIGIT IS A TWO (2)  
 I.E. 1101 FOR FIRST FLOOR  
 1201 FOR SECOND FLOOR

THIRD FLOOR UNITS THE SECOND DIGIT IS A THREE (3)  
 I.E. 1101 FOR THE FIRST FLOOR  
 1301 FOR THE THIRD FLOOR

THE THREE STORY STACKS WITH FIRST FLOOR UNIT NUMBERS OF:  
 1101, 1102, 1103, 1104, 1105, 1106, 2115, 2116, 2117,  
 2118, 3101, 3102, 3103 & 3104; ARE ONE BEDROOM UNITS.

BEACH CITY ROAD